





俊和 - 中國中鐵聯營
CHUN WO - CRGL JOINT VENTURE

Contract No. HK/2009/02
Wan Chai Development Phase II
Central - Wan Chai Bypass at Wan Chai East
Landscape Plan

Landscape Plan

Pursuant to the Further Environmental Permit -
FEP-03/356/2009

(Revision A)

Revision:	A	Prepared By:	Checked By:	Approved By:
Date:	4 Aug 2011			
		Environmental Officer Flora Ng	Quality & Environmental Manager C.P. Ho	Project Manager Chan Sing Cho



List of Contents		Page
Introduction		3
A	Landscape Works	3
B	Erection of Decorative Screen Hoarding	3
	1. Sources of Landscape Impacts	3
	2. Location, Design and Fixing Details of Hoarding	4
C	Control of Night-time Lighting	4
	1. Sources of Impacts	4
	2. Control Measures	4
D	Implementation Program, Maintenance and Management Schedule	5
	1. Implementation Programme	5
	2. Maintenance and Management Schedule	5
 List of Appendix		
A	Project's Site Boundary	3
B	Location Plan of Visual Sensitive Receivers (C25 & C26)	3
C	Location Plan of Decorative Screen Hoarding	4
D	Graphic Panels for Decorative Screen Hoarding and Its Fixing Details	4



Introduction

Pursuant to the Further Environmental Permit (No. FEP-03/356/2009) Part C Special Conditions Clause 2.18, Landscape Plan is developed by Permit Holder (Chun Wo - CRGL Joint Venture (CW-CRGL)) to demonstrate the details, locations, implementation programme, maintenance, management schedules and drawings of the landscape and visual mitigation measures to reduce the effects arising from the construction of the Wan Chai Development Phase II - Central - Wan Chai Bypass at Wan Chai East that may have on the landscape character and visual amenity. Layout plan that shows the contract site boundary is attached in Appendix A.

Great Eagle Centre (C25) and Harbour Centre (C26) are the key Visual Sensitive Receivers (VSRs) that will be affected during the Construction Phase. C25 and C26 are mapped in Appendix B.

A. Landscape Works

The landscape works that related to tree issues for this project shall be referred to the submission of Landscape Plan for FEP-01/364/2009.

B. Erection of Decorative Screen Hoarding

1. Sources of Landscape Impacts

Sources of impacts in the construction phase would include:

- The physical reclamation itself;
- Construction of new buildings, including Salt Water Pumping Station, Cooling Water, Pumping Stations;
- Construction of the Wan Chai East Sewage Outfall (DP5) and the pipe;
- Construction of noise barriers/screening/semi-enclosures;
- Construction of landscape decks;
- Construction traffic;
- The laying down of utilities, including water, drainage and power;
- Temporary site access areas, site cabins and heavy machinery;
- Construction site traffic on the reclamation;
- Increased road traffic congestion;



- After dark lighting and welding; and
- Dust during dry weather.

2. Location, Design and Fixing Details of Hoarding

The location and the graphic panels for decorative screen hoarding and its fixing details are demonstrated as Appendix G and H representatively.

C. Control of Night-time lighting

1. Sources of Impacts

Sources of impacts in the night-time construction phase would include:

- Dredging and reclamation;
- Construction of the Wan Chai East Sewage outfall and the pipe;
- The laying down of utilities, including water, drainage and power; and
- Improvement of road works.

2. Control Measures

- Any night-time work that needs to be conducted will be carefully planned to minimize the amount of unnatural light that would be needed;
- The use of equipment headlights/lighting will be first evaluated to determine sufficiency based on the task and to minimize the use of portable light plants;
- Lighting will be directed towards work areas and away from neighboring properties;
- Proper sitting and careful layout of construction activities should reduce a potential lighting exceedance;
- In the event the portable light plants are used, they will be aimed away from residential areas and used sparingly when needed. The light plant masts will also be kept at distances that would minimize the emission of light into the community, while still providing a safe work environment for employees involved in the task; and
- In addition use of vegetative and landscape buffers and other site and project elements will be used;



D. Implementation Program, Maintenance and Management Schedule

1. Implementation Programme

Item	Mitigation Measures	Location / Timing
A	Refer to Landscape Plan for of FEP-01/364/2009	
B	Erect of Decorative Screen Hoarding	All Works Area and Construction Period
C	Control of Night-Time Lighting	All Works Area and Construction Period

2. Maintenance and Management Schedule

Item	Maintenance and Management Schedule
A	<ul style="list-style-type: none">Refer to Landscape Plan for of FEP-01/364/2009
B	<ul style="list-style-type: none">Daily cleaning will be provided to prevent accumulation of debris along the site boundary area and a weekly inspection will be carried out to maintain the apparent quality of the hoarding; andIf any damage has been found, repairing works will be done as soon as possible for the affected hoarding panels.
C	<ul style="list-style-type: none">Designated site personnel will control and monitor the lighting impact during night-time construction work; andLight plants will be repositioned, redirected, lowered or shielded immediately if any public concern or complaint received.



俊和 - 中國中鐵聯營

CHUN Wo - CRGL JOINT VENTURE

LANDSCAPE PLAN

Appendix A

Project's Site Boundary

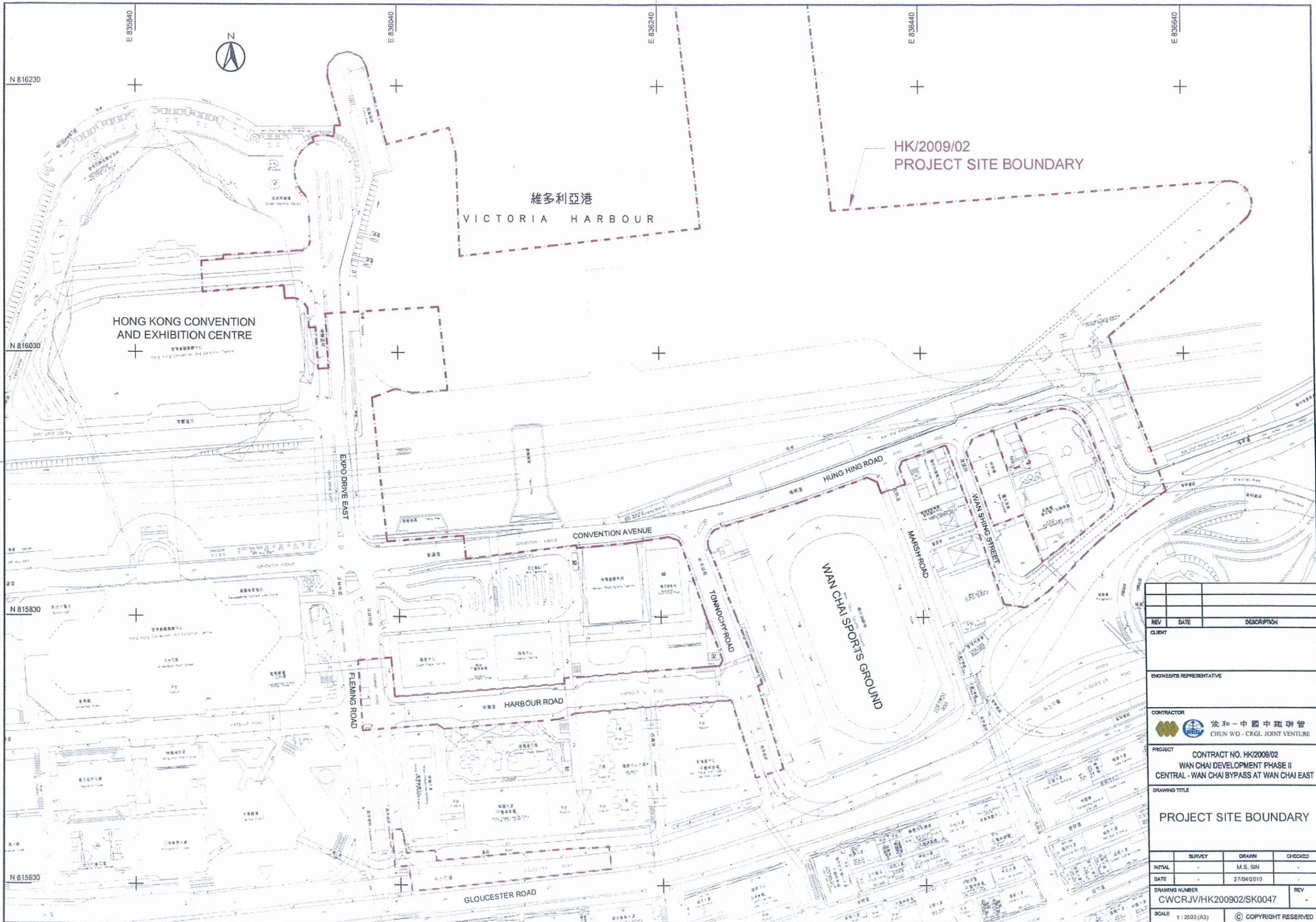

HK/2009/02
PROJECT SITE BOUNDARY

維多利亞港
VICTORIA HARBOUR

HONG KONG CONVENTION
AND EXHIBITION CENTRE

WAN CHAI SPORTS GROUND

REV	DATE	DESCRIPTION	
CLIENT			
ENGINEERS REPRESENTATIVE			
CONTRACTOR 徐和 - 中國中鐵聯合 CHUN WO - CRGL JOINT VENTURE			
PROJECT CONTRACT NO. HK/2009/02 WAN CHAI DEVELOPMENT PHASE II CENTRAL - WAN CHAI BYPASS AT WAN CHAI EAST			
DRAWING TITLE PROJECT SITE BOUNDARY			
	SURVEY	DRAWN	CHECKED
		M.S. SIN	
	DATE	27/04/2010	
	DRAWING NUMBER	CWCRJV/HK200902/SK0047	REV
	SCALE	1:2500 (A3)	© COPYRIGHT RESERVED



俊和－中國中鐵聯營

CHUN Wo－CRGL JOINT VENTURE

LANDSCAPE PLAN

Appendix B

Location Plan of Visual Sensitive Receivers (C25 & C26)

KEY FOR VISUAL SENSITIVE RECEIVERS

- C1 International Finance Centre
- C2 Hong Kong Station Development Phase 2
- C3 Exchange Square
- C4 Jardine House
- C5 Mandarin Hotel
- C6 Hong Kong Club
- C7 Ritz Carlton Hotel
- C8 AIA Tower
- C9 Hutchison House
- C10 Bank of America Tower
- C11 Far East Financial Centre
- C12 Admiralty Centre
- C13 United Centre
- C14 CMC Tower
- C15 Fleet Arcade
- C16 Astin House
- C17 Chung Nam Building
- C18 Fleet House, Harcourt House
- C19 Telecom House, Hong Kong Arts Centre, Harbour View International House
- C20 Shui On Centre
- C21 Central Plaza
- C22 Grand Hyatt Hotel
- C23 Renaissance Harbour View Hotel
- C24 Hong Kong Convention and Exhibition Centre
- C25 Great Eagle Centre
- C26 Harbour Centre
- C27 China Resources Building
- C28 Sun Hung Kai Centre
- C29 AXA Centre
- C30 Sino Plaza
- C31 World Trade Centre
- C32 Excelsior Hotel
- C33 The Park Lane Hotel
- C34 Windsor House
- C35 18-31 Yee Wo Street
- C36 Chicorp Centre
- C37 Victoria Centre
- C38 Ocean Terminal
- C39 Star House
- C40 Peninsula Hotel
- C41 Sheraton Hotel
- C42 InterContinental Hotel
- C43 New World Centre and Hotel
- C44 Wing On Plaza
- C45 Shangri-La Hotel
- C46 Yau Sha Tsui Centre
- C47 Empire Centre
- C48 Grand Stanford Harbour View Hotel
- C49 Nikko Hotel
- C50 Four Season Hotel
- C51 Harbour Plaza Metropark
- C52 AM Tower
- C53 Newton Hotel
- C54 Electric Centre
- C54A Sea View Estate

- CR1 Causeway Centre
- CR2 163-165 Gloucester Road
- CR3 219-226 Gloucester Road
- CR4 Elizabeth House
- CR5 Riviera Mansions
- CR6 Prospect Mansions
- CR7 Miami Mansions
- CR8 Marco Polo Mansions
- CR9 Victoria Park Mansions
- CR10 Chesterfield Mansions
- CR11 Greenfield Mansions
- CR12 Properties fronting Causeway Road
- CR13 Park Towers
- CR14 Viking Garden
- CR15 50-51 Hong Fai Street
- CR16 Mayson Garden Building
- CR17 Garden House
- CR18 Bafo House
- CR19 Top Glory Tower
- CR20 Hoi Kung Court
- CR21 Hoi To Court
- CR22 Hoi Dea Court
- CR23 Pacific Place Complex

- GIC1 General Post Office
- GIC2 City Hall
- GIC3 PLA Headquarters at Tamar
- GIC4 Hong Kong Police Force Headquarters, May House
- GIC5 Revenue Tower
- GIC6 Wan Chai Tower
- GIC7 Police Officers' Club
- GIC8 Queen's College
- GIC9 Hong Fat Street Post Office
- GIC10 Victoria Park School for the Deaf
- GIC11 YMCA
- GIC12 Electric Road Municipal Seniors Building
- O1 Fenwick Pier Street Public Open Space
- O2 HKCEC Extension Open Space and Promenade
- O3 HKCEC Extension Open Space and Promenade
- O4 Renaissance Harbour View Plaza
- O5 Central Plaza Open Space
- O6 Wanchai Sports Ground
- O7 Tunnel Approach Rest Garden
- O8 Victoria Park
- O9 Yau Sha Tsui Waterfront Promenade
- O11 Royal Hong Kong Yacht Club

- R1 Residential Properties fronting Tung Lo Wan Road
- R4 Harbour Heights
- R5 Residential Properties fronting King Wah Road
- R6 City Garden
- R7 Provident Centre
- S1 Harbour Traffic
- T1 Wanchai North Road Network - vehicular - pedestrian
- T2 Gloucester Road Corridor - vehicular - pedestrian
- T3 Island Eastern Corridor

LEGEND

- PLANNING AND ENGINEERING REVIEW STUDY AREA BOUNDARY
- - - LIMIT OF PRIMARY ZONE OF VISUAL INFLUENCE
- [C1] BOUNDARY OF KEY VSRs
- △ PHOTO TAKING POINT WITH PHOTO NO.
- [] COMMERCIAL
- [] COMMERCIAL / RESIDENTIAL
- [] RESIDENTIAL
- [] RECREATIONAL
- [] GOVERNMENT / INSTITUTION / COMMUNITY
- [] TRANSPORT
- [DP1] CENTRAL-WANCHAI BYPASS (CWB) INCLUDING ITS ROAD TUNNEL AND SLIP ROADS
- [DP2] ROAD P2 AND OTHER ROADS WHICH ARE CLASSIFIED AS PRIMARY/DISTRICT DISTRIBUTOR ROADS
- [DP3] RECLAMATION WORKS INCLUDING ASSOCIATED DREDGING WORKS
- [DP4] TEMPORARY TYPHOON SHELTER

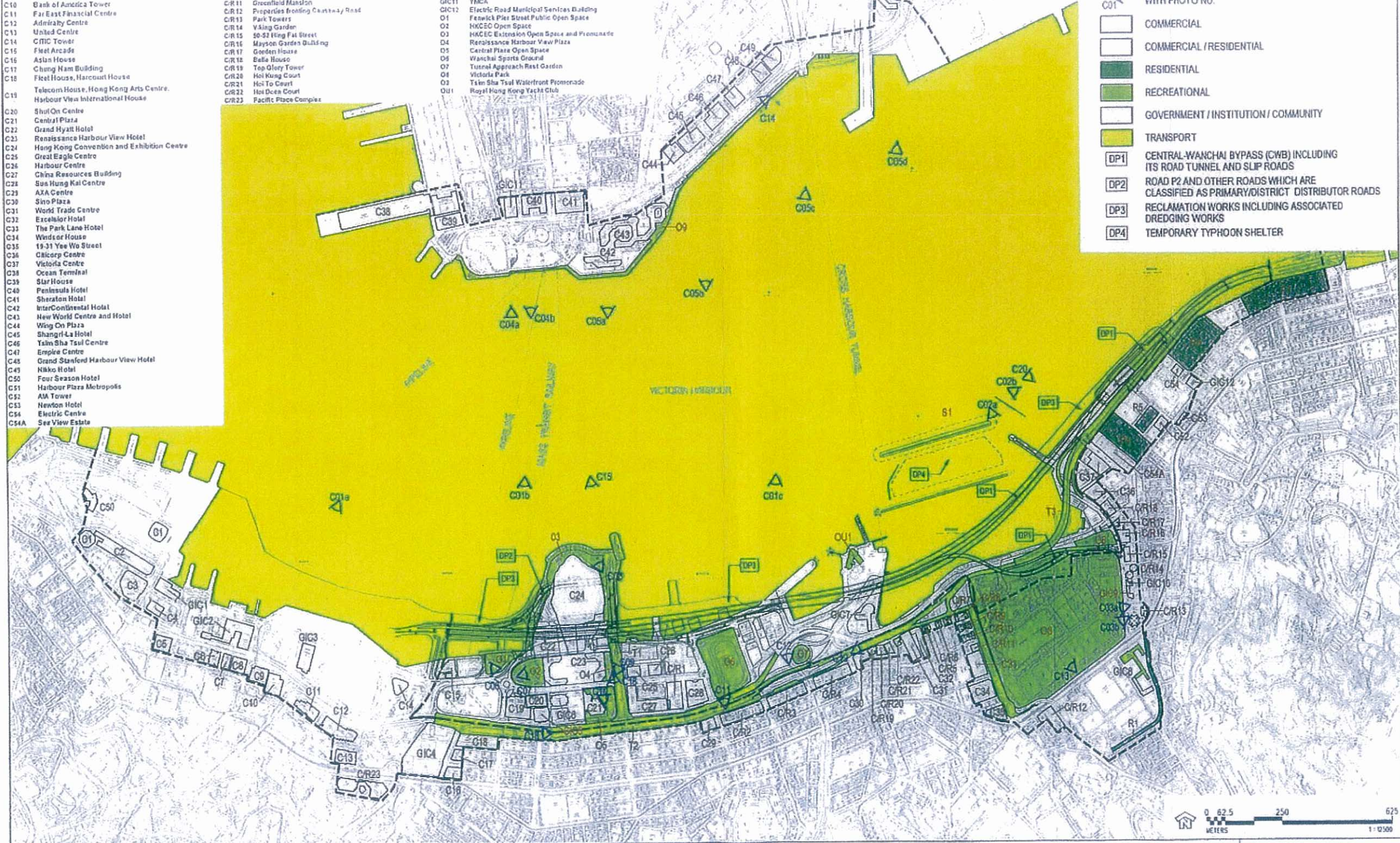

WAN CHAI DEVELOPMENT PHASE II - PLANNING AND ENGINEERING REVIEW

KEY VSRs AND PRIMARY ZONE OF VISUAL INFLUENCE DURING CONSTRUCTION

FIGURE 10.4

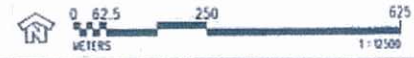

10/10/2007 11:16:51



俊和 - 中國中鐵聯營

CHUN Wo - CRGL JOINT VENTURE

LANDSCAPE PLAN

Appendix C

Location Plan of Decorative Screen Hoarding

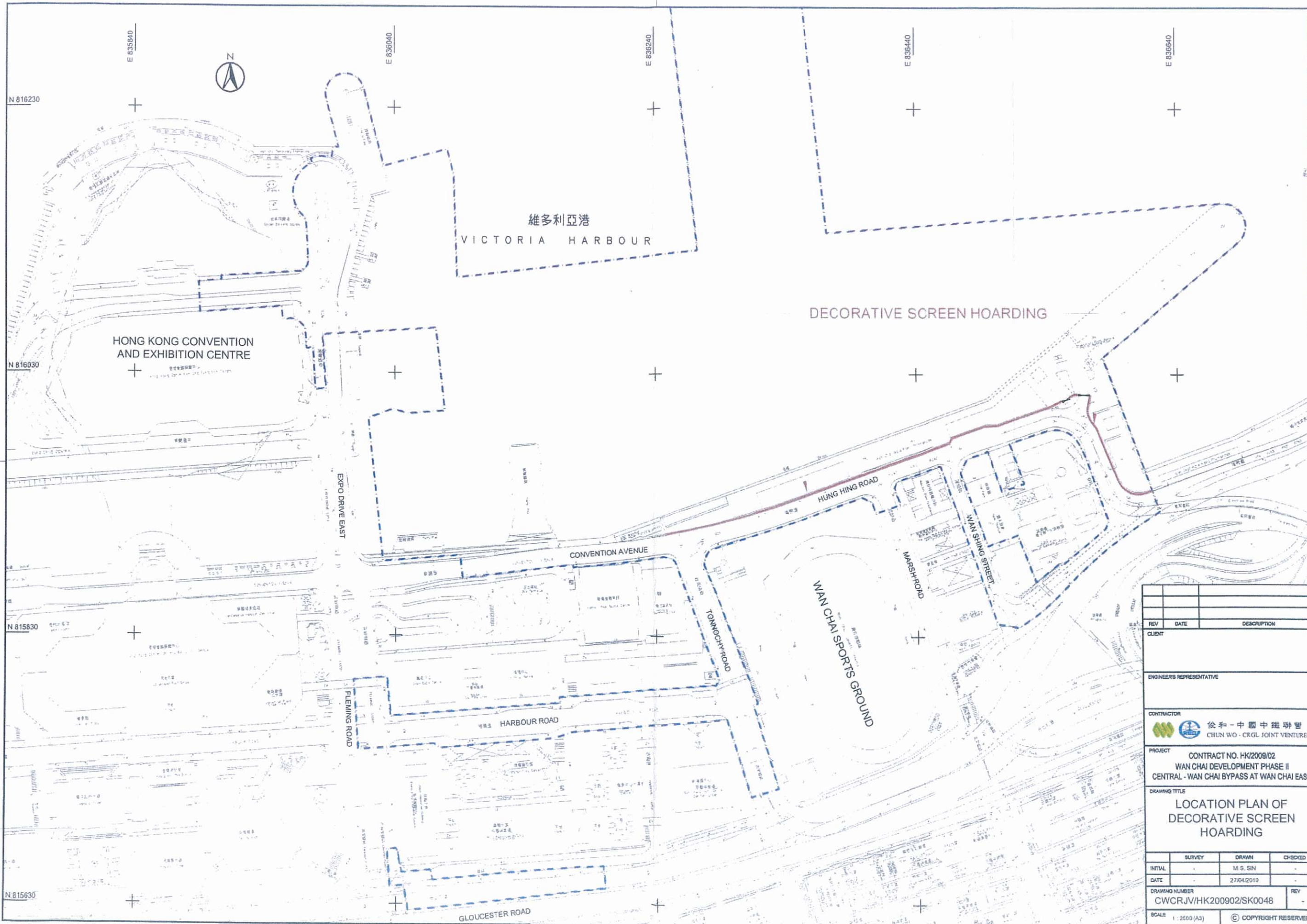

REV	DATE	DESCRIPTION	
CLIENT			
ENGINEER'S REPRESENTATIVE			
CONTRACTOR 徐和 - 中國中鐵聯營 CHLN WU - CRGL JOINT VENTURE			
PROJECT CONTRACT NO. HK2009/02 WAN CHAI DEVELOPMENT PHASE II CENTRAL - WAN CHAI BYPASS AT WAN CHAI EAST			
DRAWING TITLE			
LOCATION PLAN OF DECORATIVE SCREEN HOARDING			
	SURVEY	DRAWN	CHECKED
INITIAL	-	M.S. SIN	-
DATE	27/04/2010		-
DRAWING NUMBER		REV	
CWCRJV/HK200902/SK0048		-	
SCALE 1 : 2500 (A3)		© COPYRIGHT RESERVED	

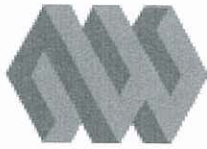

俊和－中國中鐵聯營

CHUN Wo－CRGL JOINT VENTURE

LANDSCAPE PLAN

Appendix D

**Graphic Panels for Decorative Screen Hoarding and Its
Fixing Details**

NOTE:
 1. ALL DIMENSIONS ARE IN MILLIMETERS
 2. FIXING DETAILS FOR POSTS AND PANELS REFER SKETCH NO. SK0037

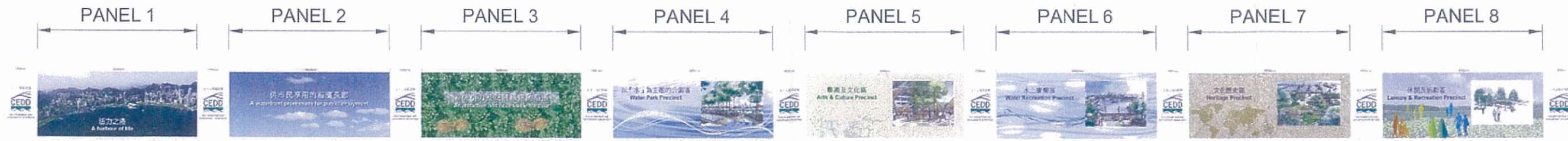

TYPICAL ARRANGEMENT OF DESIGNATED THEME HOARDING

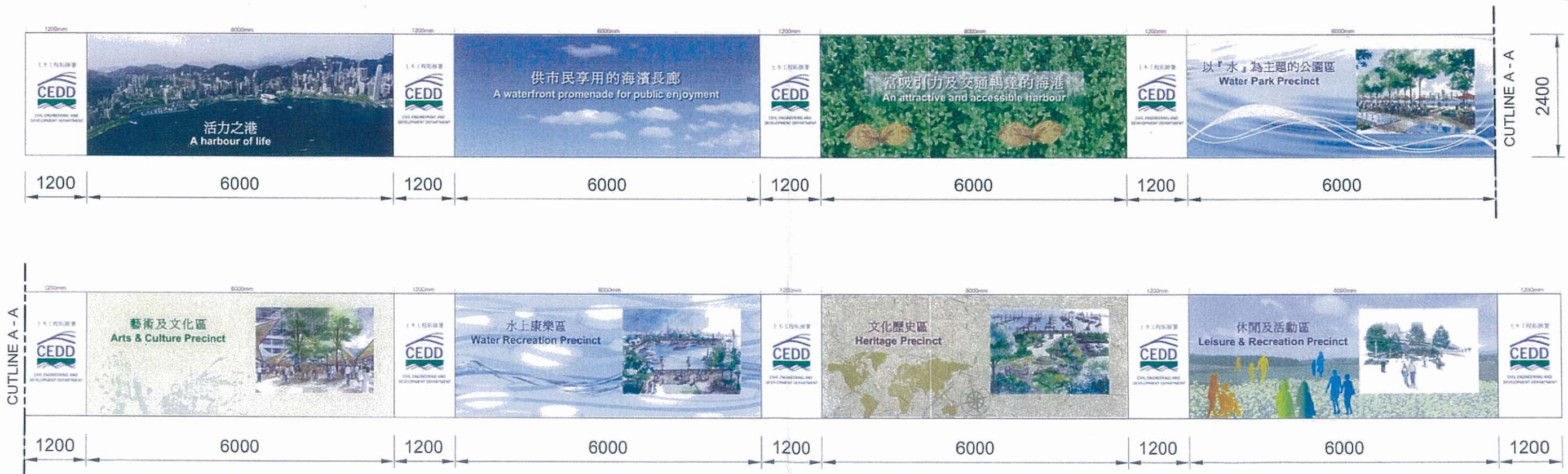

DETAILS

CLIENT	CONTRACTOR 俊和 - 中國中鐵聯營 CHUN WO - CRGL JOINT VENTURE	JOB TITLE:	SCALE	N.T.S.	REF. TO DWG NO.	CW-CR/ENG/ENG-0118	
			DATE	12 APR 2010		Sheet of	
ENGINEER'S REPRESENTATIVE	PROJECT: CONTRACT NO. HK/2009/02 WAN CHAI DEVELOPMENT PHASE II - CENTRAL - WAN CHAI BYPASS AT WAN CHAI EAST	ADDITIONAL GRAPHIC PANELS ON TYPE I HOARDING	DRAWN	M.S. SIN	DESIGNED	SKETCH NO	REV
			CHECKED	-	APPROVED	CWCRJV/HK200902/SK0036	A

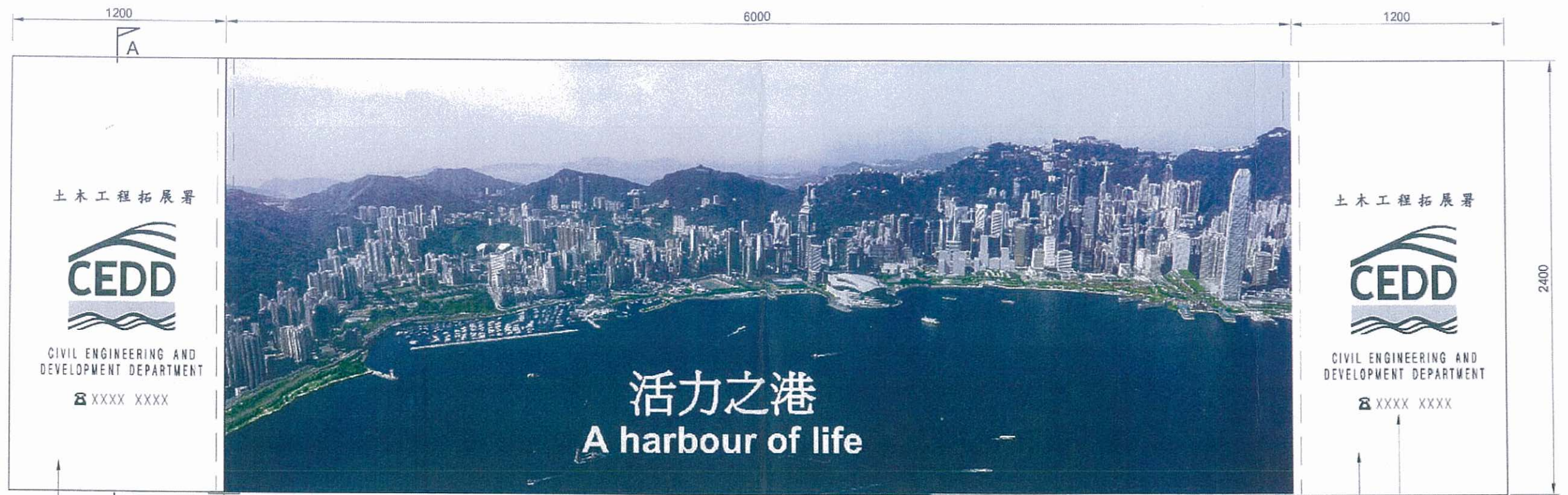

TYPICAL FRONT ELEVATION
SCALE 1 : 25 (A3)

1.5 THK STEEL SHEET LOGO PANEL AT FULL HEIGHT OF THE HOARDING FIXED TO CORRUGATED STEEL CLADDING BY 4 NOS. M10 GMS SCREW & NUT WITH WASHER

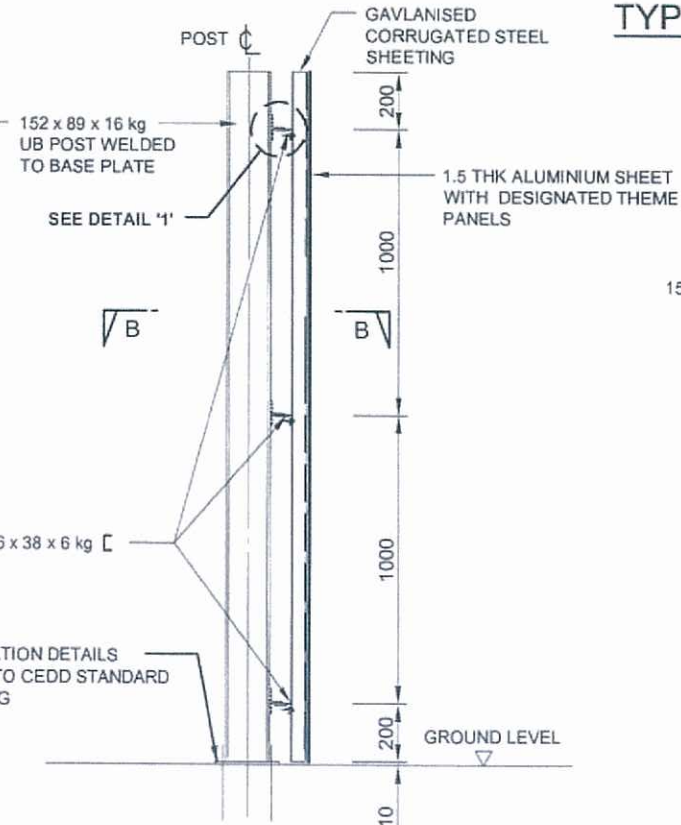

SECTION A - A
SCALE 1 : 25 (A3)

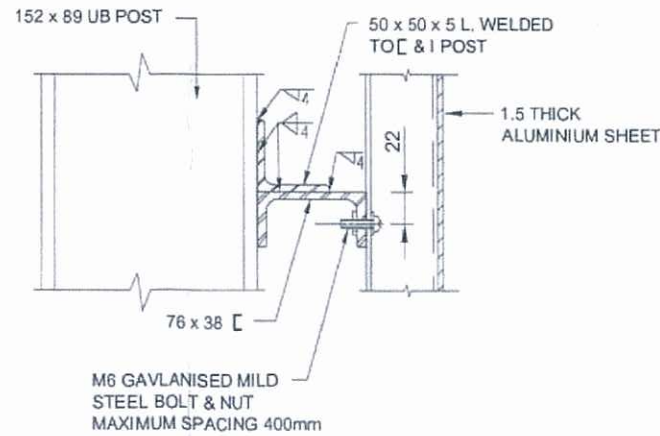

DETAIL '1'
SCALE 1 : 5 (A3)

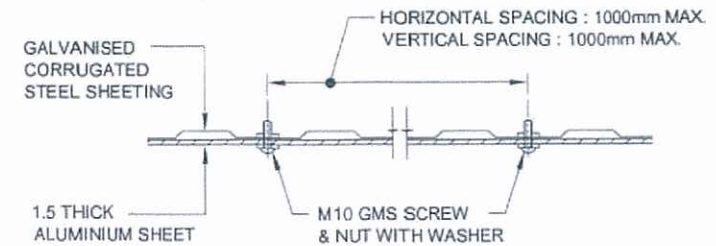

SECTION B - B
SCALE 1 : 5 (A3)

NOTES:

1. ALL DIMENSIONS ARE MILLIMETERS.
2. CORRUGATED STEEL SHEETING SHALL HAVE SECTION MODULUS NOT LESS THAN 2000mm³ m. THE SHEETING SHALL BE TO B.S. 3083 8/3 G350.
3. REFER TO LATEST VERSION OF DRG. NO. C1001 FOR DETAILS OF THE DEPARTMENTAL LOGO.
4. THE TELEPHONE NO. FOR ANY ENQUIRES OR COMPLAINTS SHALL BE GIVEN BY THE ENGINEER.

SEE NOTE NO. 4
WHITE COLOUR OF LOGO PANEL

CLIENT	CONTRACTOR	JOB TITLE:	SCALE	AS SHOWN	REF. TO DWG NO.	CW-CR/ENG/ENG-0119	
	 俊和 - 中國中鐵聯營 CHUN WO - CRGL JOINT VENTURE		FIXING DETAILS FOR POSTS AND PANELS	DATE	12 APR 2010		Sheet of
ENGINEER'S REPRESENTATIVE	PROJECT:		DRAWN	M.S. SIN	DESIGNED	SKETCH NO	REV
	CONTRACT NO. HK/2009/02 WAN CHAI DEVELOPMENT PHASE II - CENTRAL - WAN CHAI BYPASS AT WAN CHAI EAST		CHECKED	-	APPROVED	CWCRJV/HK200902/SK0037	-



Lam Geotechnics Limited

Ground Investigation & Instrumentation Professionals

華益土力有限公司

Ref : G1001/CS/L409/FEP-03/356/2009
Date : 4 August 2011

Chun Wo – CRGL Joint Centure

5C, Hong Kong Spinners Industrial Building, Phase I,
602 – 603 Tai Nan Street,
Cheung Sha Wan
Kowloon

Attn: Mr. Chan Sing Cho, Project Manager

Dear Sir,

Further Environmental Permit no. FEP-03/356/2009

Contract No. HK/2009/02

**Wanchai Development Phase II – Central –Wan Chai Bypass at Wan Chai East
Landscape Plan (Revision A)**

Referring to your submission of the captioned plan (Revision A dated 4 August 2011) received through email on 4 August 2011, we have reviewed your submitted details and hereby certify this submission in accordance with Condition 2.18 of Further Environmental Permit no. FEP-03/356/2009.

Should you have any enquiry, please feel free to contact the undersigned at 2839 5666.

Yours faithfully,

Raymond Dai
Environmental Team Leader

c.c.

CEDD	- Mr. Patrick Keung	(By Fax: 2577 5040)
AECOM (WDII)	- Mr. Frankie Fan	(By Fax: 2587 1877)
ENVIRON	- Mr. David Yeung	(By Fax: 3548 6988)



Ref.: AACWBIECEM00_0_1645L.11

5 August 2011

Chun Wo – CRGL Joint Venture
5C, Hong Kong Spinners Industrial Building Phase 1
601-603 Tai Nan West Street
Cheung Sha Wan
Kowloon

By Post and E-mail

Attention: Mr. Chan Sing Cho (Project Manager)

Dear Sir,

Re: FEP-03/356/2009

Contract No. HK/2009/02

Wan Chai Development Phase II – Central-Wan Chai Bypass at Wan Chai East

Landscape Plan (Revision A)

Reference is made to Chun Wo – CRGL Joint Venture's submission of Landscape Plan (Revision A dated 4 August 2011) received through E-mail on 4 August 2011 for our review and comment.

Please be informed that we have no adverse comments on the captioned submission. We write to verify the captioned submission in accordance with Condition 2.18 of FEP-03/356/2009.

Yours sincerely,



David Yeung
Independent Environmental Checker

c.c.	CEDD	Mr. Patrick Keung	by fax: 2577 5040
	AECOM	Mr. Frankie Fan (PRE)	by fax: 2587 1877
	AECOM	Mr. Kelvin Cheng	by fax: 2691 2649
	LAM	Mr. Raymond Dai	by fax: 2882 3331

Q:\Projects\AACWBIECEM00\Corr\AACWBIECEM00_0_1645L.11.doc